

CUMEEIRA DUPLA para pendente > 7%

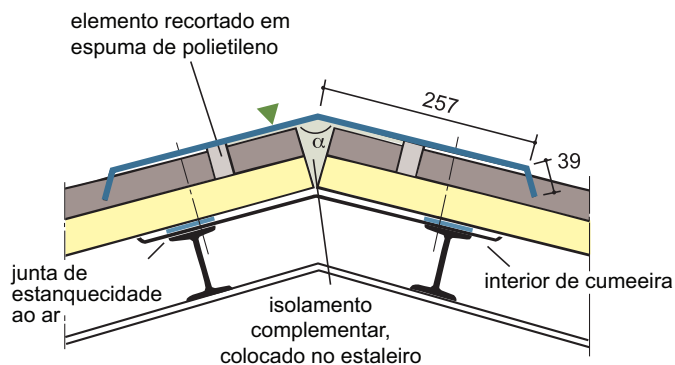

α - a definir pelo cliente

CUMEEIRA DUPLA VENTILADA : AT FDA1

Espessura standard : 0,75 mm (aço galvanizado ou galvanizado pré-lacado).
Extremidades sob encomenda, (não incluídos).
Peça quinada.

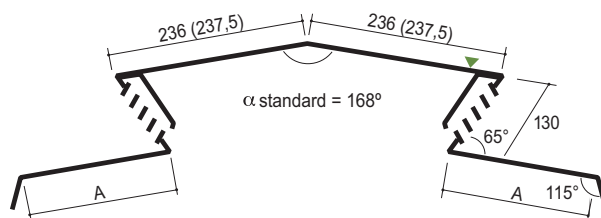

secção de ventilação
= 400 cm² por metro e por face.

▼ Face pré-lacada

CUMEEIRA DUPLA - AT FD2

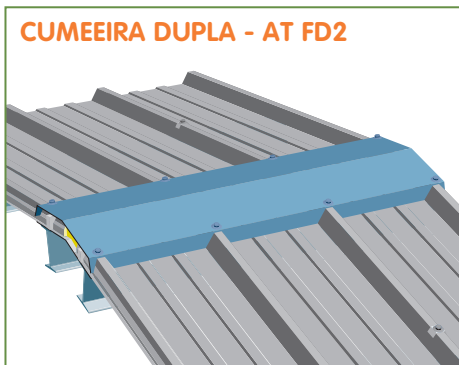

CUMEEIRA DUPLA VENTILADA : AT FDA1

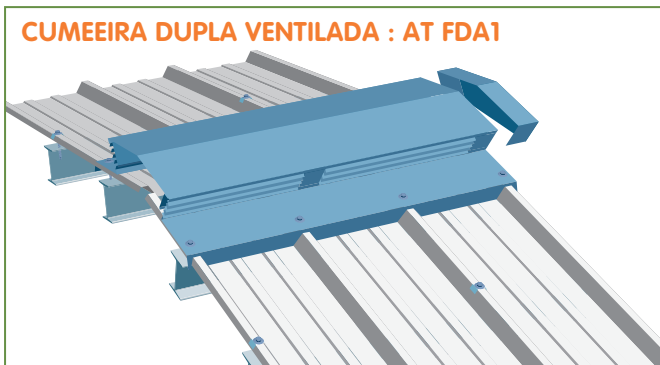

CUMEEIRA DUPLA para pendentes entre 5 e 7%

CUMEEIRA CURVA POR QUINAGEM

▼ Face pré-lacada

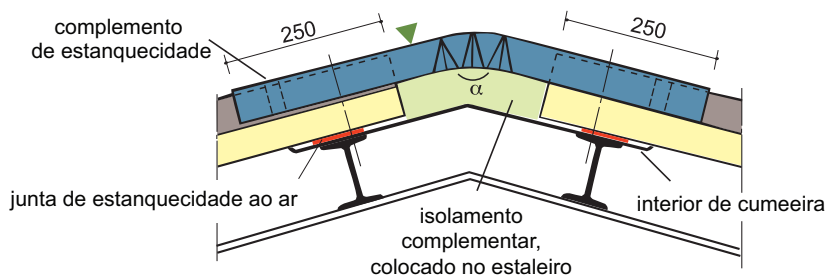

α: a definir pelo cliente

PARTE INFERIOR DA CUMEEIRA DUPLA - AT SF1

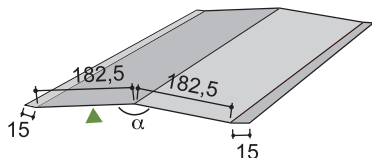

α - a definir pelo cliente

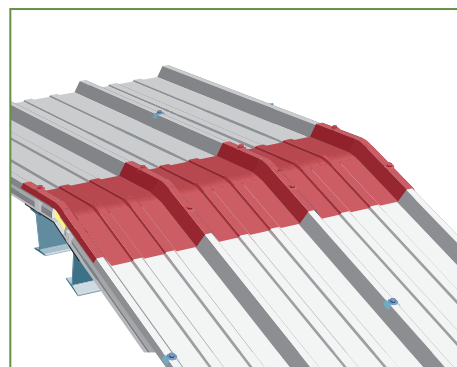

CUMEEIRA SIMPLES

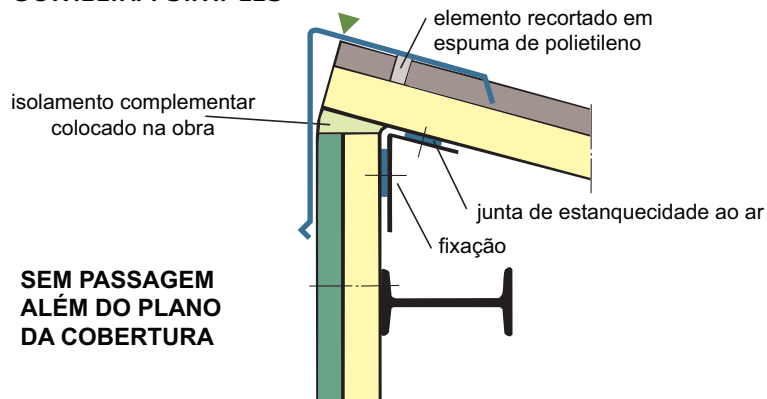

CUMEEIRA SIMPLES - AT FF 1 ou 2

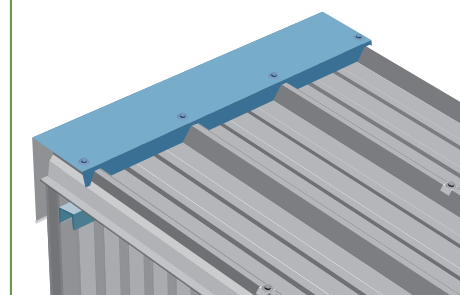

▼ Face pré-lacada

COM PASSAGEM DO PLANO DE COBERTURA

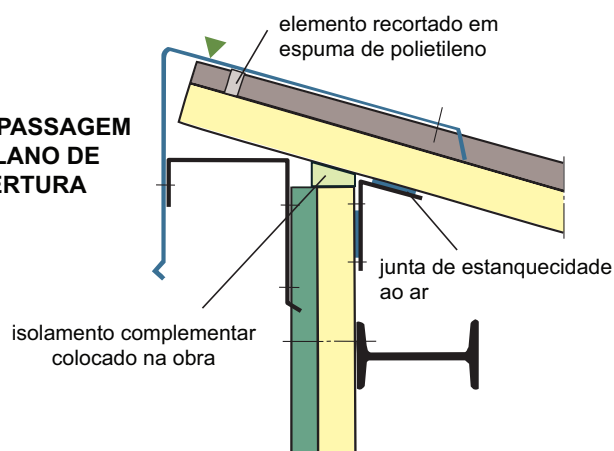

AT FF 1

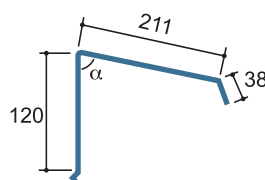

AT FF 2

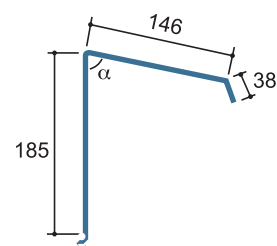

CUMEEIRA EM SOLEIRA

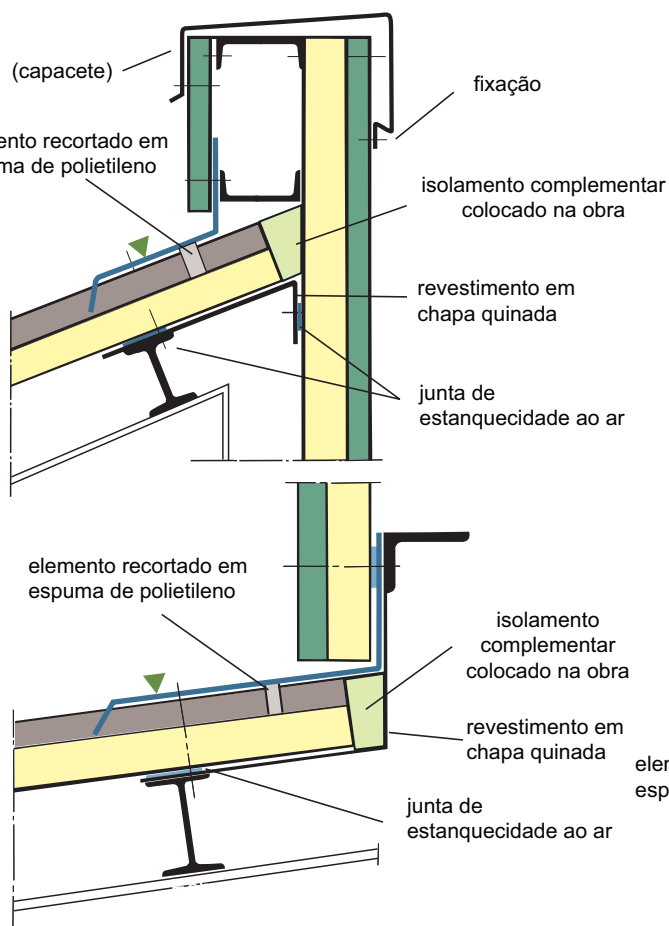

CUMEEIRA EM SOLEIRA AT FS 1

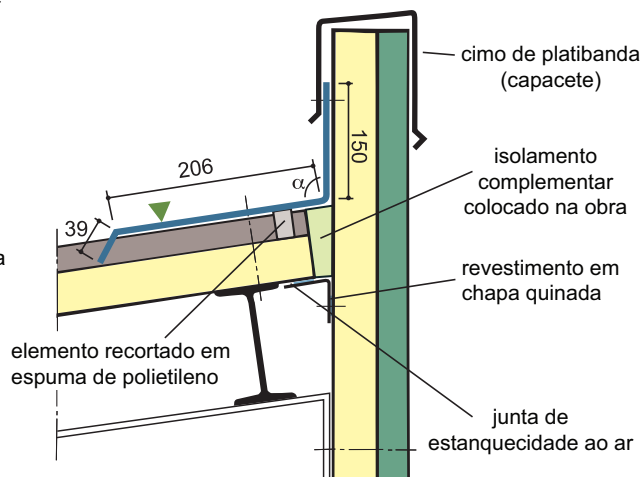
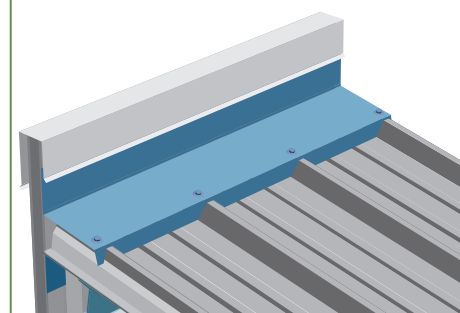

REMATES LONGITUDINAIS

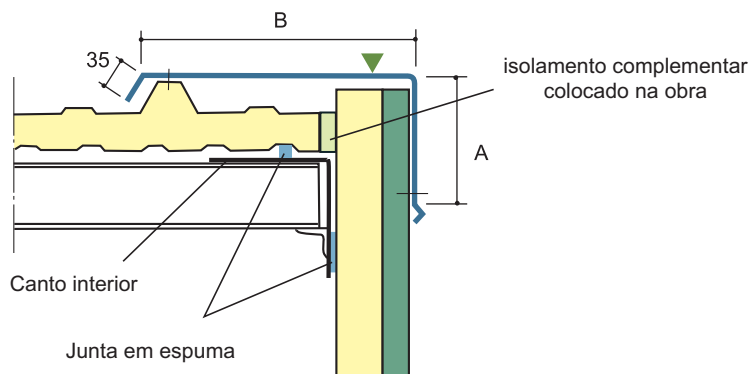

Remate de extremidade AT RP

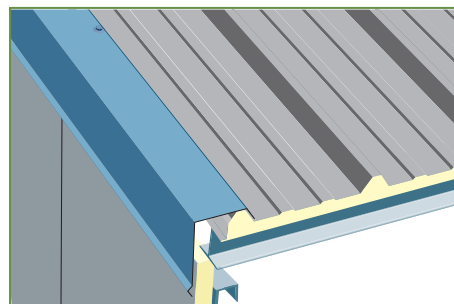

▼ Face pré-lacada

REMATES LATERAIS

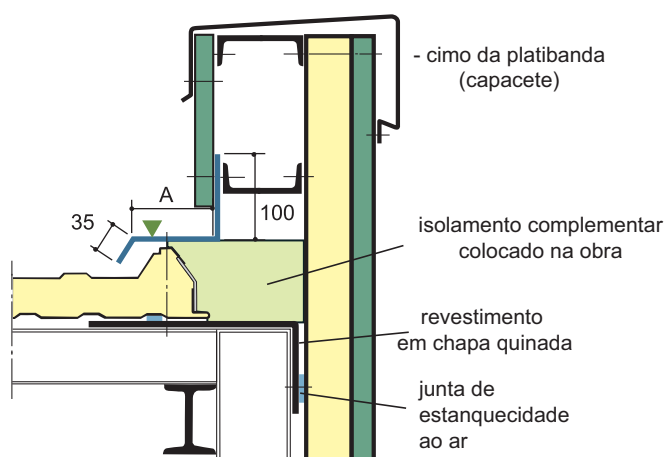

Remate em soleira

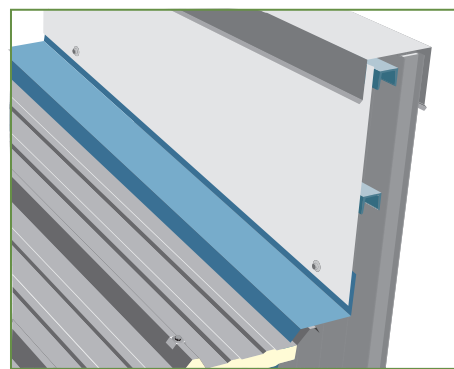

PARAMENTOS

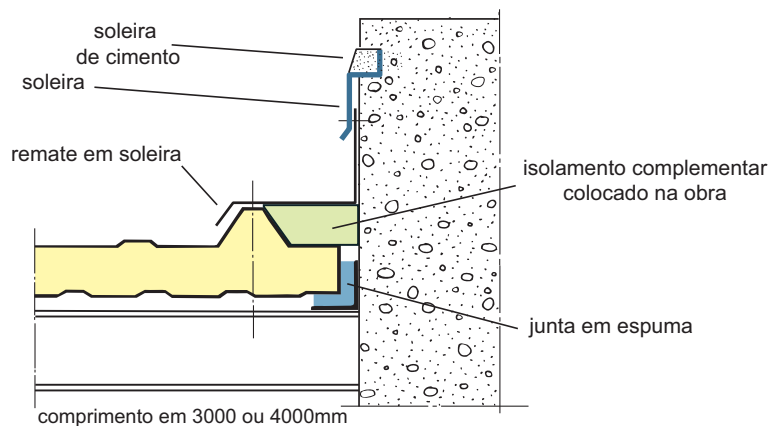

AT SO1

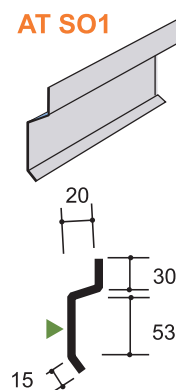

AT SO2

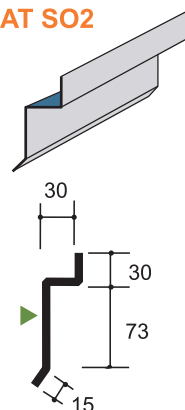

EXTREMIDADE DA PENDENTE

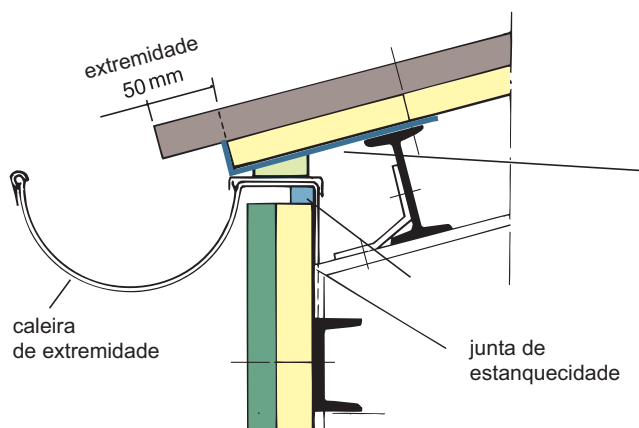

Extremidade com caleira

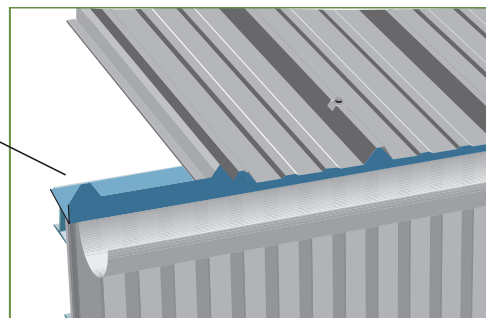

remate
ver página 8

EXTREMIDADE DA PENDENTE

EXTREMIDADE SEM CALEIRA

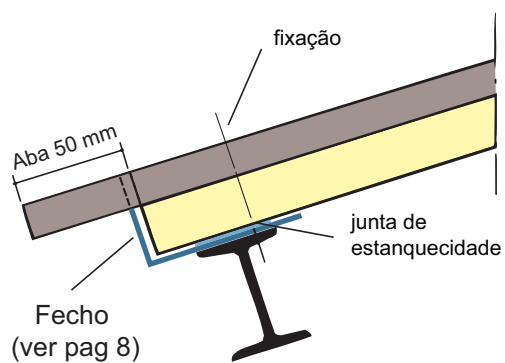

EXTREMIDADE COM CALEIRA:

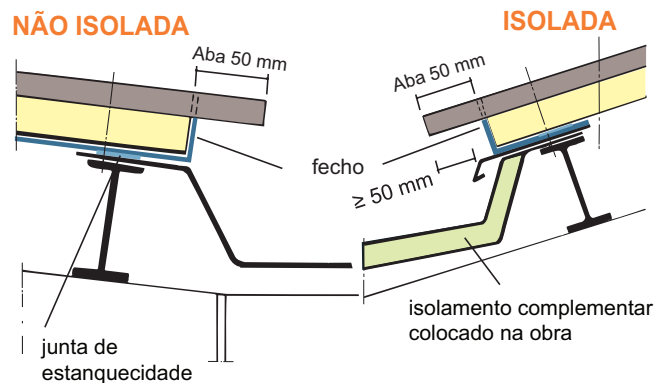

EXTREMIDADE DA PENDENTE EM CURVA POR QUINAGEM

